

HAZET – Screwdrivers

Perfect tools for perfect results

- ✓ **HEXAnamic** Screwdrivers
- ✓ **TRInamicULTRA** Screwdrivers
- ✓ **trinamic®** Screwdrivers
- ✓ **Screwdrivers for Electricians (VDE)**
- ✓ **Electronic** Screwdrivers
- ✓ **Offset** Screwdrivers and many more...
- ✓ Blades made of high-quality special steel
- ✓ Ergonomically shaped handles avoiding bruises on the hands
- ✓ Always the correct profile:
 - ⊖
 - ⊕
 - ✱
 - ✳
 - ✴
 - ⊙
- ✓ Blades with hex-bolster for higher torque values

New range of **HEXAnamic** Screwdrivers

Ergonomically shaped screwdrivers designed according to the latest developments in research

NEW
HEXAnamic
Screwdrivers

Component 3 (soft):
Antislip protection for axial contact pressure

Non-slippery even with greasy hands

Component 2 (hard):
More stability against impacts

Component 1 (hard):
Blade firmly fixed to the handle

With recessed hexagon at the front of the handle:
– Antislip protection
– Anti-roll protection

Well-sized quick-rotation area

6 deepened gripping areas for high power transmission

HEXAnamic

Grey-coated tips for perfect fitting in the screw profile

Our classics



- ✓ **TRInamicULTRA**
- ✓ 2-component handle
- ✓ With **impact cap** for more power



- ✓ **trinamic®**
1-component handle, ergonomically shaped and extremely sturdy

Please note ...

... our extensive range of screwdriver bits from page 152 on.

HEXAnamic Screwdriver



- The new **HEXAnamic Screwdriver**
- 3-component handle cover, designed according to **latest know-how in cooperation with leading German work scientists**:
 - component 1 (hard): optimal blade fixation
 - component 2 (hard): stability against impacts
 - component 3 (soft): protection against slipping off at axial contact pressure
- Anatomically shaped for perfect coupling between hand and screwdriver
- Recessed hexagon at the front of the handle:
 - **optimized protection against slipping-off**
 - prevents the screwdriver from unintended sliding-off
- Non-slippery even with oily hands
- Optimized quick-rotation area
- Resistant against petrol, acid, Skydrol, brake fluid, etc.
- Blade made of high-quality special steel, chrome-plated
- With grey tips for optimal protection against corrosion and perfect hold of the blade in the screwdriver head

For slotted screws

ISO 2380-1:2004, ISO 2380-2:2004
From size 55 on blade with hex bolster for use with a wrench, allows application of high torque values

HAZET No.	l_1 mm	l_2 mm	$\frac{+}{-}$ mm	$\frac{+}{-}$ mm	EAN-No. 4000896+
802- 30	80	179	3,5	0,6	144785
802- 40	100	199	4,0	0,8	144808
802- 55	125	239	5,5	1,0	144815
802- 65	150	264	6,5	1,2	144822
802- 80	150	279	8,0	1,2	144839
802-100	175	304	10,0	1,6	144846
802-120	200	329	12,0	2,0	144853



- For **Phillips-Recess screws PH**
- ISO 8764-1:2004, ISO 8764-2:2004
- From size PH 3 on, blade with hex bolster

HAZET No.	l_1 mm	l_2 mm	\varnothing mm	EAN-No. 4000896+
802-PH 0	60	159	-	144860
802-PH 1	80	194	-	144884
802-PH 2	100	214	-	144907
802-PH 3	150	279	13	144921



- For **POZIDRIV® screws PZ**
- ISO 8764-1:2004, ISO 8764-2:2004
- From size PZ 3 on, blade with hex bolster

HAZET No.	l_1 mm	l_2 mm	\varnothing mm	EAN-No. 4000896+
802-PZ 0	60	159	-	145058
802-PZ 1	80	194	-	145065
802-PZ 2	100	214	-	145072
802-PZ 3	150	279	13	145089

HEXAnamic TORX® Screwdriver

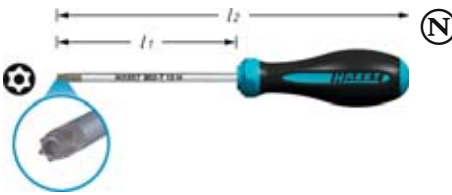

- For **tamper resistant TORX® screws** (inside TORX® screws with pin)
- With front hole

HAZET No.	l_1 mm	l_2 mm	\varnothing mm	EAN-No. 4000896+
802-T 8 H	60	159	2,31	145102
802-T 9 H	60	159	2,50	145119
802-T 10 H	80	179	2,74	145126
802-T 15 H	80	179	3,27	145133
802-T 20 H	100	214	3,86	145140
802-T 25 H	100	214	4,43	145164
802-T 27 H	115	229	4,99	145171
802-T 30 H	115	229	5,52	145188
802-T 40 H	130	259	6,65	145195
802-T 45 H	130	259	7,82	145201

HEXAnamic Screwdriver Set



* = in plastic drawer insert

HAZET No.	EAN-No. 4000896+
6 pieces	
Contents:	
802-40 55 65 80	802-PH1 PH2
802/6 *	145560
10 pieces	
Contents:	
802-30 40 55 65 80 100	
802-PH 1 PH 2	801 K-55 801 K-PH 2
802/10	145577
5 pieces	
Contents:	
802-T10H T15H T20H T25H T30H	
802 T H/5 *	145591
7 pieces	
Contents:	
802-T 8H T 9H T10H T15H T20H T25H T30H	
802 T H/7	145607

Screwdriver



- With handles made of Durethan®
- According to **Swiss standard VSM 35601**
- Blades offset, parallel faces
- Chrome-Vanadium
- Blades mat chrome-plated, tips burnished
- Protected by design patent

HAZET No.	$\frac{+}{-}$ mm	$\frac{+}{-}$ mm	l_1 mm	EAN-No. 4000896+
800-00	0,3	2,0	70	032037
800-0	0,4	2,5	80	032020
800-1	0,5	3,5	90	032044
800-2	0,6	4,0	100	032051

Screwdriver

HAZET No.	$\frac{+}{-}$ mm	$\frac{+}{-}$ mm	l_1 mm	EAN-No. 4000896+
800-3	0,8	5,5	120	032068
800-4	1,0	6,5	140	032075
800-5	1,2	8,0	160	032082
800-6	1,6	10,0	180	032099



- For **Phillips-Recess screws PH**

HAZET No.	l_1 mm	EAN-No. 4000896+
800-PH 0	60	032136
800-PH 1	80	032143
800-PH 2	100	032150



- For **POZIDRIV® screws PZ**

HAZET No.	l_1 mm	EAN-No. 4000896+
800-PZ 0	60	032167
800-PZ 1	80	032174
800-PZ 2	100	032181

Screwdriver Set



* = in HAZET plastic drawer insert

HAZET No.	EAN-No. 4000896+
6 pieces:	
Contents:	
800-1 2 3 4 5 6	
800/6 *	032198
8 pieces:	
Contents:	
800-1 2 3 5 800-PH 1 PH 2 PZ 1 PZ 2	
800/8	032211
8 pieces:	
Contents:	
800-1 2 3 4 5 800-PH 0 PH 1 PH 2	
800/8-1	032228

TRInamicULTRA Screwdriver



- For **slotted screws**
- Short style
- 2-component handle

HAZET No.	l_1 mm	l_2 mm	$\frac{+}{-}$ mm	$\frac{+}{-}$ mm	EAN-No. 4000896+
801 K-35	25	89	3,5	0,6	079964
801 K-55	25	89	5,5	1,0	079971
801 K-80	25	89	8,0	1,2	079988

TRInamicULTRA Screwdriver



- For Phillips-Recess screws PH
- Short style
- 2-component handle

HAZET No.	l ₁ mm	l ₂ mm	EAN-No. 4000896+
801 K-PH 1	25	89	080038
801 K-PH 2	25	89	080045



- For POZIDRIV® screws PZ
- Short style
- 2-component handle

HAZET No.	l ₁ mm	l ₂ mm	EAN-No. 4000896+
801 K-PZ 1	25	89	080090
801 K-PZ 2	25	89	080106

TRInamicULTRA Screwdriver with Impact Cap



- Multicomponent handle provides optimal surfaces and a very good grip
- Impact cap made of tempered steel
- Blades with hex bolster for use with a wrench
- DIN 5265 form D, edges according to DIN 5264
- Chrome-Vanadium
- Blades chrome-plated, tips burnished

HAZET No.	l ₁ mm	l ₂ mm	∩ mm	≠ mm	EAN-No. 4000896+
801 U-45	90	199	4,5	0,7	109395
801 U-55	100	209	5,5	0,8	109401
801 U-70	125	248	7,0	1,0	109418
801 U-PH 1	90	194	-	-	109692
801 U-PH 2	100	223	-	-	109708
801 U-PH 3	150	282	-	-	118328

5 pieces, cardboard packed

Contents:

801 U-45 55 70 801 U-PH 1 PH2

801 U/5 109388

trinamic® Screwdriver



- With trinamic handle
- Ergonomic design and high capacity
- High power transmission
- Chrome-Vanadium
- Blades chrome-plated, tips burnished
- German registered design

- For slotted screws

- DIN 5265, C-series

* = blade with hex bolster for use with a wrench - allows application of high torque values

HAZET No.	l ₁ mm	l ₂ mm	∩ mm	≠ mm	EAN-No. 4000896+
803-20	63	126,5	2,0	0,4	077434
803-25	75	138,5	2,5	0,4	077441
803-30	80	151,5	3,0	0,5	077458
803-35	100	180	3,5	0,6	077465
803-40	100	189,5	4,0	0,8	077472
803-55	125	226	5,5	1,0	077489
803 S-55 *	125	218	5,5	1,0	089109
803-65	150	251	6,5	1,2	077496
803 S-65 *	150	260	6,5	1,2	089116
803-80 *	150	268,5	8,0	1,2	077502
803-100 *	175	303	10,0	1,6	077519
803-120 *	200	328	12,0	2,0	077526
803-140 *	250	378	14,0	2,5	077533



- For Phillips-Recess screws PH
- From size PH 3 on, blade with hex bolster
- DIN ISO 8764-2, ISO 8764-2

HAZET No.	l ₁ mm	l ₂ mm	∩ mm	EAN-No. 4000896+
803-PH 0	60	138	-	077557
803-PH 1	80	168	-	077564
803-PH 2	100	200	-	077571
803-PH 3	150	265,5	13	077588
803-PH 4	200	325	16	077595



- For POZIDRIV® screws PZ
- Marking ring blue
- From size PZ 3 on, blade with hex bolster

HAZET No.	l ₁ mm	l ₂ mm	∩ mm	EAN-No. 4000896+
803-PZ 0	53,5	137,5	-	077625
803-PZ 1	73	166,5	-	077632
803-PZ 2	94,5	199,5	-	077649
803-PZ 3	142	265	13	077656
803-PZ 4	192	324	16	077663

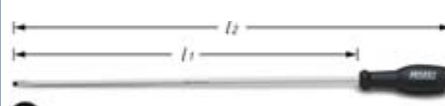

- For deeply located slotted screws
- Extra-long style

HAZET No.	l ₁ mm	l ₂ mm	∩ mm	≠ mm	EAN-No. 4000896+
803 Lg-55	410	520,5	5,5	1,0	077540

trinamic® Screwdriver

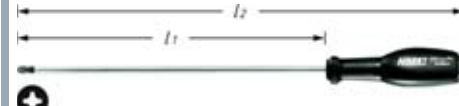

- For deeply located Phillips-Recess screws PH
- Extra-long style

HAZET No.	l ₁ mm	l ₂ mm	EAN-No. 4000896+
803 Lg-PH 1	250	340	077601
803 Lg-PH 2	250	351	077618

TORX® trinamic® Screwdriver



- For inside TORX® screws

HAZET No.	l ₁ mm	l ₂ mm	∩ mm	EAN-No. 4000896+
803-T 6	48	112	1,67	077670
803-T 7	48	112	1,99	077687
803-T 8	55	127	2,31	077694
803-T 9	55	127	2,50	077700
803-T 10	70	150	2,74	077717
803-T 15	70	150	3,27	077724
803-T 20	84	175	3,86	077731
803-T 25	84	175	4,43	077748
803-T 27	99	200	4,99	077755
803-T 30	99	200	5,52	077762
803-T 40	99	217	6,65	086214
803-T 45	112	230	7,82	086221



- For inside TORX® screws
- Long, slim style
- Application e.g. at the dashboard, car body, engine compartment as well as in industry

HAZET No.	l ₁ mm	l ₂ mm	∩ mm	EAN-No. 4000896+
803 Lg-T 15	250	330	3,27	087785
803 Lg-T 20	250	343	3,86	087792
803 Lg-T 25	250	345	4,43	087808
803 Lg-T 30	250	360	5,52	087815

Screwdriver for Electricians

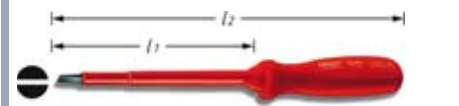

- For working on live parts, tension range to AC 1000 V and DC 1500 V
- All-insulated, red, according to standard DIN EN / IEC 60900
- For slotted screws
- Edges according to DIN 5264, form A
- Wedge-shaped
- Tips burnished

HAZET No.	l ₁ mm	l ₂ mm	∩ mm	≠ mm	EAN-No. 4000896+
803 VDE-25	75	155	2,5	0,4	079544
803 VDE-30	100	180	3,0	0,5	077786
803 VDE-35	100	190	3,5	0,6	077793
803 VDE-40	100	190	4,0	0,8	077809
803 VDE-55	125	225	5,5	1,0	077816
803 VDE-65	150	250	6,5	1,2	077823

Parallel tips

803 VDE-80 175 285 8,0 1,2 077830

Screwdriver for Electricians



- For Phillips-Recess screws PH
- All-insulated, red, DIN EN / IEC 60900
- Tips burnished

HAZET No.	l ₁ mm	l ₂ mm	EAN-No. 4000896+
803 VDE-PH 0	60	140	077847
803 VDE-PH 1	80	170	077854
803 VDE-PH 2	100	200	077878
803 VDE-PH 3	150	260	077861

Screwdriver Set



In plastic drawer insert (except for 803/6-2, 803 T/5, 803 T/7, 803 Lg-T/4)

HAZET No.	EAN-No. 4000896+
6 pieces	
Contents:	
803-40 55 65 80	
803-PH 1 PH 2	
803/6	080373

6 pieces	
Contents:	
803-40 55 65 80	
803-PZ 1 PZ 2	
803/6-1	080380

6 pieces	
Contents:	
803-25 30 35 40 55 65	
803/6-2	084777

10 pieces	
Contents:	
803-25 30 35 40 65 80	
803-PH 1 PH 2	
801 K-55 801 K-PH 2	
803/10	080236

13 pieces	
Contents:	
801 K-55 801 K-PH 2	
803-25 30 35 40 65 80	
803-PZ 1 PZ 2	
803-PH 1 PH 2 PH 3	
803/13	098514

For inside TORX® screws, 5 pieces	
Contents:	
803-T10 T15 T20 T25 T30	
803 T/5	080410

Screwdriver Set

HAZET No. EAN-No. 4000896+

7 pieces	
Contents:	
803-T8 T9 T10 T15 T20 T25 T30	
803 T/7	087334

Long style, for inside TORX® screws 4 pieces	
Contents:	
803 Lg-T15 T20 T25 T30	
803 Lg-T/4	098798

Screwdriver Set for Electricians, 6 pieces	
Contents:	
803 VDE-25 40 55 65	
803 VDE-PH 1 PH 2	
803 VDE/6	080229

Clip Screwdriver



- The versatile screwdriver for everyday-use – always ready to hand
- With fibre reinforced scraper for damage-free removing of stickers etc.
- Clip holds screwdriver tight in every pocket, e.g. breast or sleeve pocket
- Rotating clip improves handling
- Blade chrome-plated
- For slotted screws
- DBGm – German registered utility model

HAZET No.	l ₁ mm	l ₂ mm	∩ mm	∩ mm	EAN-No. 4000896+
805 C-25	30	130	2,5	0,4	089123

Electronic Screwdriver

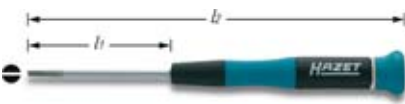

- New handles - new design
- For smallest screws
- With revolving-head
- Best grip due to recessed handle
- Chrome-Vanadium
- Blades burnished

• For slotted screws					
• Marking ring grey					
HAZET No.	l ₁ mm	l ₂ mm	∩ mm	∩ mm	EAN-No. 4000896+
805-015	60	153	1,5	0,3	032587
805-02	60	153	2,0	0,4	032594
805-025	75	168	2,5	0,4	032600
805-03	75	168	3,0	0,5	032617

Electronic Screwdriver



- For Phillips-Recess screws PH
- Marking ring yellow

HAZET No.	l ₁ mm	l ₂ mm	EAN-No. 4000896+
805-PH 00	60	153	032631
805-PH 0	60	153	032624
805-PH 1	80	173	032648



- For inside hexagon screws
- Marking ring orange

HAZET No.	l ₁ mm	l ₂ mm	EAN-No. 4000896+
806-0,7	60	153	057627
806-0,9	60	153	057634
806-1,3	60	153	057641
806-1,5	60	153	057658
806-2,0	60	153	057665
806-2,5	60	153	057672
806-3,0	60	153	057689



- For outside hexagon screws
- Marking ring green

HAZET No.	l ₁ mm	l ₂ mm	EAN-No. 4000896+
807-2,5	60	153	057696
807-3,0	60	153	057702
807-3,2	60	153	057719
807-3,5	60	153	057726
807-4,0	60	153	057733
807-5,0	60	153	057740
807-5,5	60	153	057757



- For inside TORX® screws
- Marking ring red

HAZET No.	l ₁ mm	l ₂ mm	∩ mm	EAN-No. 4000896+
808-T 5	60	153	1,42	057764
808-T 6	60	153	1,67	057771
808-T 7	60	153	1,99	057788
808-T 8	60	153	2,31	057795
808-T 9	60	153	2,50	057801
808-T 10	60	153	2,74	057818
808-T 15	80	173	3,27	057825



Electronic Screwdriver Set



- For slotted and Phillips-Recess screws
- 7 pieces, in plastic box

Contents:
805-015 02 025 03
805-PH00 PH0 PH1

HAZET No.	EAN-No. 4000896+
805/7	032655



- For inside hexagon screws
- 7 pieces, in plastic box

Contents:
806-0,7 0,9 1,3 1,5 2,0 2,5 3,0

HAZET No.	EAN-No. 4000896+
806/7	055036



- For outside hexagon screws
- 7 pieces, in plastic box

Contents:
807-2,5 3,0 3,2 3,5 4,0 5,0 5,5

HAZET No.	EAN-No. 4000896+
807/7	055043



Components and Spare Parts see pages 240 to 249

Electronic Screwdriver Set

- For inside TORX® screws
 - 7 pieces, in plastic box
- Contents:
808-T5 T 6 T 7 T 8
T 9 T10 T15

HAZET No.	EAN-No. 4000896+
808/7	055050

Screwdriver



- With wooden handle
- With blade passing through the handle
- For slotted screws
- Blade with hex bolster

HAZET No.	l ₁ mm	l ₂ mm	□ mm	♣ mm	EAN-No. 4000896+
815-1	100	200	5,5	0,8	033096
815-2	125	235	6,5	1,0	033102
815-3	150	270	8,0	1,2	033119
815-4	175	300	10,0	1,6	033126
815-5	200	330	12,0	2,0	033133
815-6	250	380	14,0	2,5	033140



- For Phillips-Recess screws PH
- From size PH 3 on, blade with hex bolster

HAZET No.	l ₁ mm	l ₂ mm	∅ mm	EAN-No. 4000896+
815-PH 1	80	180	-	077885
815-PH 2	100	210	-	077892
815-PH 3	150	265	13	077908
815-PH 4	200	335	16	077915

Screwdriver Set

Cardboard packed, 5 pieces

Contents:
815-1 2 3
815-PH 1 PH 2

HAZET No.	EAN-No. 4000896+
815/5	033157

Offset Screwdriver



- For slotted screws
- Chrome-Vanadium
- Surface chrome-plated
- DIN 5200

HAZET No.	l ₁ mm	l ₂ mm	□ mm	♣ mm	EAN-No. 4000896+
818-1	90	8,5	3,5	0,6	033164
818-2	125	10,5	5,5	1,0	033171
818-3	150	17,0	8,0	1,2	033188
818-4	175	24,0	10,0	1,6	033195

Offset Screwdriver



- For Phillips-Recess screws PH
- DIN 5208

HAZET No.	l ₁ mm	l ₂ mm	EAN-No. 4000896+
819-PH 1 + PH 2	125	20	033201
819-PH 2 + PH 3	150	29	033218

Hollow Three-Square Scraper



Tips ground

HAZET No.	l ₁ mm	l ₂ mm	EAN-No. 4000896+
821-1	150	260	033683
821-2	200	315	033690

Angle Scraper

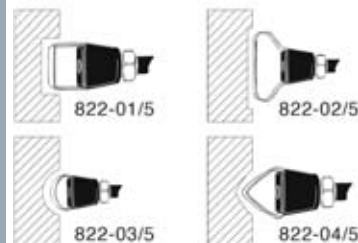
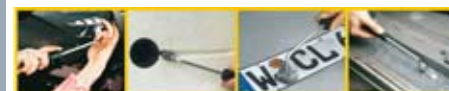

- For removal of underseal (esp. PVC), antidrumming compound, joint sealant, stickers, etc.
- Scraping of sealing residues, e.g. at the cylinder head
- Scraping cable channels in Ytong blocks
- Environmentally friendly working::
 - no formation of dust
 - no formation of noise
 - no formation of chloric or dioxin gas (as it occurs e.g. when burning residues)
- With replaceable and reversible blades made of HSS bimetal
 - shape of blades see illustration -
- Various applications possible due to different blade shapes and a total length of 270 mm
- Chrome-Vanadium
- Surface chrome-plated

HAZET No.	b mm	l mm	EAN-No. 4000896+
822	20	270	033713

Blade Set for 822
(5 pieces per set)
cardboard packed

HAZET No.	b mm	l mm	EAN-No. 4000896+
822-01/5	20	-	033720
822-02/5	42	-	033744
822-03/5	21,5 / r 12,5	-	033751
822-04/5	21 / 110°	-	033768

Fine Three-Square Scraper



- With protective coating made of viscoplastic and impact-resistant plastic material
- With protection cap
- Special steel

HAZET No.	l ₁ mm	l ₂ mm	EAN-No. 4000896+
823	25	148	033874

Blunt Scraper



- For the removal of sealing residues
- **824 long blade**
- **824-1 short blade**
- Special steel
- Surface galvanized

HAZET No.	∩ mm	l ₁ mm	l ₂ mm	EAN-No. 4000896+
824	23	150	270	033881
824-1	23	55	165	033898



With exchangeable hard-metal tip

HAZET No.	∩ mm	l ₁ mm	l ₂ mm	EAN-No. 4000896+
825-25	25	267	397	033959

Exchangeable Hard-Metal Tip



Exchangeable hard-metal tip for 825-25

HAZET No.	∩ mm	l ₁ mm	EAN-No. 4000896+
825-025	25	25	033928

Screwdriver

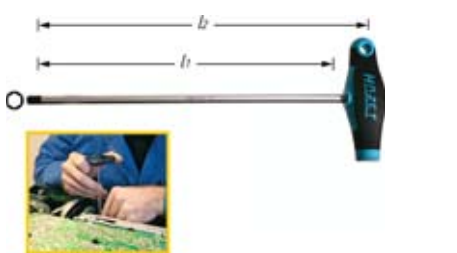

- For inside hexagon screws
- With ergonomically shaped 2-component T-handle
- Chrome-Vanadium
- Surface chrome-plated, tips burnished

Screwdriver

HAZET No.	l ₁ mm	l ₂ mm	S mm	EAN-No. 4000896+
828- 2	100	118	2	034123
828- 2,5	110	118	2,5	034130
828- 3	150	168	3	034161
828- 4	150	176	4	034192
828- 5	200	226	5	034222
828- 6	200	234	6	034246
828- 8	200	234	8	034260
828-10	200	234	10	034109

TORX® Screwdriver

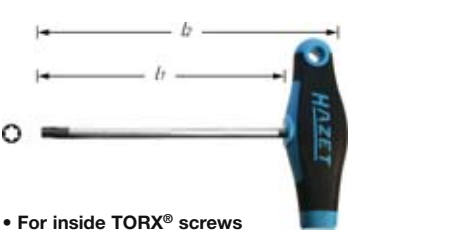

- For inside TORX® screws
- With ergonomically shaped 2-component T-handle
- Chrome-Vanadium
- Surface chrome-plated, tips burnished

HAZET No.	l ₁ mm	l ₂ mm	mm	EAN-No. 4000896+
828-T 6	80	98	1,67	034451
828-T 7	80	98	1,99	034468
828-T 8	80	98	2,31	034475
828-T 9	80	98	2,50	034482
828-T 10	100	126	2,74	034291
828-T 15	100	126	3,27	034307
828-T 20	100	126	3,86	034321
828-T 25	110	136	4,43	034345
828-T 27	120	146	4,99	034376
828-T 30	130	156	5,52	034383
828-T 40	130	164	6,65	034413
828-T 45	130	164	7,82	034420
828-T 50	130	164	8,83	034437

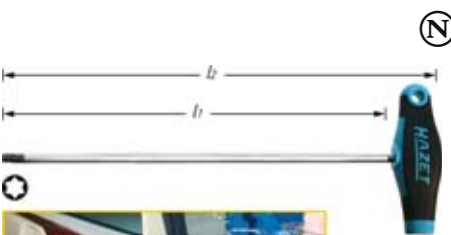

- For inside TORX® screws
- Extra long style
- With ergonomically shaped 2-component T-handle
- Chrome-Vanadium
- Surface chrome-plated, tips burnished

HAZET No.	l ₁ mm	l ₂ mm	mm	EAN-No. 4000896+
828 Lg-T 20	200	226	3,86	139941
828 Lg-T 30	290	316	5,52	116638

Screwdriver



- For inside hexagon screws
- With ergonomically shaped 2-component T-handle with lateral blade
- The design of the screwdrivers ensures an efficient and flexible application under different accessibility conditions
- Chrome-Vanadium
- Surface chrome-plated, tips burnished

HAZET No.	l ₁ mm	l ₂ mm	S mm	EAN-No. 4000896+
829-2	100	118	2	133796
829-2,5	100	118	2,5	133819
829-3	150	168	3	133826
829-4	150	176	4	133833
829-5	200	176	5	133840
829-6	200	234	6	133857

TORX® Screwdriver



- For inside TORX® screws
- With ergonomically shaped 2-component T-handle with lateral blade
- The design of the screwdrivers ensures an efficient and flexible application under different accessibility conditions
- Chrome-Vanadium
- Surface chrome-plated, tips burnished

HAZET No.	l ₁ mm	l ₂ mm	mm	EAN-No. 4000896+
829-T 15	100	126	3,27	133727
829-T 20	100	126	3,86	133734
829-T 25	110	136	4,43	133741
829-T 27	120	146	4,99	133758
829-T 30	130	156	5,52	133765
829-T 40	130	164	6,65	133772

Voltmeter



- 220-250 V according to standard VDE 0680
- Slotted blade, concave ground
- Extra long handle, 92 mm
- With clip
- Defective glow tube not replaceable according to VDE

HAZET No.	l ₁ mm	l ₂ mm	EAN-No. 4000896+
839-1	58	150	035670
839-2	61	150	080441

HAZET Thread Repair Sets

Cost-saving repair of damaged or worn-out threads

- ✓ For application / threads M 5, M 6, M 7, M 8, M 9, M 10, M 11, M 12, M 14
- ✓ High-quality stainless chrome-nickel steel provides good female threads resisting the influences of temperature and corrosion
- ✓ **Application:** Thread plating of materials presenting a low shearing resistance, e.g. aluminium and magnesium alloys; in machine construction, automotive engineering, electrical and medical engineering as well as in aircraft and aerospace.

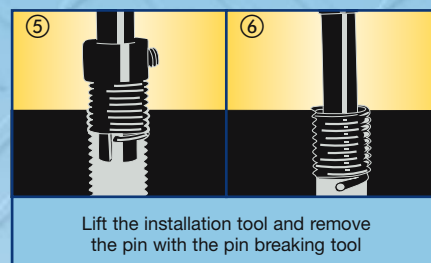
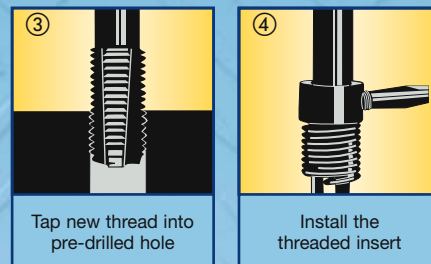
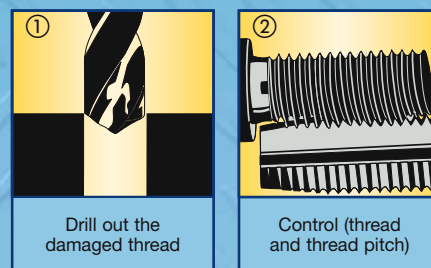

Complete assortments with twist drill, installation tool, screw tap, pin breaking tool and threaded inserts

Information:
Structure of the article number of the thread repair sets:
842-8 x 1.0/24

Thread diameter M 8
Thread pitch 1.0
Packing unit 24 pieces

Length dimensions ^l_{mm} of the built-in threaded inserts

3

Screw Extractor



- For turning out worn screws and bolts with right-handed thread
- Ground
- Chrome-Vanadium

HAZET No.	∅ mm	EAN-No. 4000896+
840-1	1,4- 3,6	035687
840-2	2,1- 4,9	035694
840-3	3,1- 6,5	035700
840-4	4,8- 8,8	035717
840-5	6,2-11,0	035724
840-6	9,4-15,0	035731
840-7	12,7-19,0	035748
840-8	17,5-24,0	035755

Screw Extractor Set



In plastic box

HAZET No.	EAN-No. 4000896+
5 pieces	
Contents: 840-1 2 3 4 5	
840/5	035762
8 pieces	
Contents: 840-1 2 3 4 5 6 7 8	
840/8	035786

Stud Extractor Set

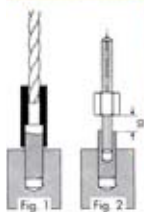

- For turning out broken bolts and screws
- ∅ 6 to 15 mm
- Application:
 1. Bore up with drill and tapping sleeve
 2. Insert grooved stud extractor
 3. Put on union nut and screw out broken bolt or screw
- Special steel
- Surface burnished

HAZET No.	EAN-No. 4000896+
Set of 25 pieces in plastic box	
841/25	060993

Stud Extractor Set

HAZET No.	EAN-No. 4000896+
Union Nuts	
841-01	074433
841-02	074440
841-03	074457
841-04	074464
841-05	074471
Tapping Sleeves	
841-06	074488
841-07	074495
841-08	074501
841-09	074518
841-010	074525
841-011	074532
841-012	074549
841-013	074556
841-014	074563
841-015	074570

Tapping Sleeve	Drill-∅ mm	Stud-Extractor	Suitable for
841- 06	4	841-016	M 5 3/16"
841- 07	4	841-016	M 6 9/32" 1/4"
841- 08	4	841-016	M 7 9/32"
841- 09	4	841-016	M 8 5/16"
841-010	5	841-017	M 8 5/16"
841-011	5	841-017	M 9 11/32"
841-012	5	841-017	M10 3/8"
841-013	6	841-018	M11 7/16"
841-014	7,5	841-019	M12 19/32"
841-015	8,5	841-020	M14 9/16"

Thread Repair Set



- For the **repair** of damaged or worn-out threads
- **Thread plating** of materials presenting a low shearing resistance, e.g. aluminium and magnesium alloys; application in machine construction, automotive engineering, electrical and medical engineering.
- Reuse of rejects
- High-quality chrome-nickel stainless steel provides good female threads resisting the influences of weathering and corrosion
- Complete sets with twist drill, installation tool, screw tap, pin breaking tool and threaded inserts
- Application:
 - ① Drill out the damaged thread
 - ② Control (thread and thread pitch)
 - ③ Tap new thread into pre-drilled hole
 - ④ Install the threaded insert
 - ⑤ Lift the installation tool
 - ⑥ Remove the drive pin with the pin breaking tool

Thread Repair Set

Length dimensions l_{mm} of the built-in threaded inserts

HAZET No.	M	l mm	EAN-No. 4000896+
Thread Repair Set M 5			
24 pieces:			
20 threaded inserts M 5 x 0.8 x 6.7 mm			
1 part each: twist drill, tap, installation tool, pin breaking tool			
842-5/24	M 5 x 0,8	6.7	119295
Refill Set 10 pieces M 5 x 0.8			
842-05/10			124442
Thread Repair Set M 6			
24 pieces:			
20 threaded inserts M 6 x 1.0 x 8 mm			
1 piece each: twist drill, tap, installation tool, pin breaking tool			
842-6/24	M 6 x 1,0	8	119301
Refill Set 10 pieces M 6 x 1.0			
842-06 K x 1,0/10			135196
842-06/10			124459
842-06 L x 1,0/10			135189
Thread Repair Set M 7			
24 pieces:			
20 threaded inserts M 7 x 1.0 x 9.5 mm			
1 piece each: twist drill, tap, installation tool, pin breaking tool			
842-7 x 1,0/24	M 7 x 1,0	9.5	134960
Refill Set 10 pieces M 7 x 1.0			
842-07 x 1,0/10			135080
Thread Repair Set M 8			
24 pieces:			
20 threaded inserts M 8 x 1.25 x 10.8 mm			
1 piece each: twist drill, tap, installation tool, pin breaking tool			
842-8/24	M 8 x 1,25	10.8	119318
Refill Set 10 pieces M 8 x 1.25			
842-08 K x 1,25/10			135226
842-08/10			124466
842-08 L x 1,25/10			135202
Thread Repair Set M 8			
24 pieces:			
20 threaded inserts M 8 x 1.0 x 11 mm			
1 piece each: twist drill, tap, installation tool, pin breaking tool			
842-8 x 1,0/24	M 8 x 1,0	11	134984
Refill Set 10 pieces M 8 x 1.0			
842-08 x 1,0/10			135103
Thread Repair Set M 9			
24 pieces:			
20 threaded inserts M 9 x 1.25 x 12.3 mm			
1 piece each: twist drill, tap, installation tool, pin breaking tool			
842-9 x 1,25/24	M 9 x 1,25	12.3	135004
Refill Set 10 pieces M 9 x 1.25			
842-09 x 1,25/10			135110
Thread Repair Set M 10			
14 pieces:			
10 threaded inserts M 10 x 1.5 x 13.5 mm			
1 piece each: twist drill, tap, installation tool, pin breaking tool			
842-10/14	M 10 x 1,5	13.5	119325
Refill Set 10 pieces M 10 x 1.5			
842-010 K x 1,5/10			135240
842-010/10			124473
842-010 L x 1,5/10			135233
Thread Repair Set M 10			
14 pieces:			
10 threaded inserts M 10 x 1.0 x 14 mm			
1 part each: twist drill, tap, installation tool, pin breaking tool			
842-10 x 1,0/14	M 10 x 1,0	14	135028
Refill Set 10 pieces M 10 x 1.0			
842-010 x 1,0/10			135134

Thread Repair Set

Length dimensions l_{mm} of the built-in threaded inserts (E)

HAZET No.	M	l mm	EAN-No. 4000896+
Thread Repair Set M 10			
14 pieces:			
10 threaded inserts M 10 x 1.25 x 13.8 mm			
1 piece each: twist drill, tap, installation tool, pin breaking tool			
842-10 x 1,25/14	M 10 x 1,25	13.8	135011
Refill Set 10 pieces M 10 x 1.25			
842-010 x 1,25/10			135127

Thread Repair Set M 11

14 pieces:			
10 threaded inserts M 11 x 1.5 x 15 mm			
1 piece each: twist drill, tap, installation tool, pin breaking tool			
842-11 x 1,5/14	M 11 x 1,5	15	135035

Refill Set 10 pieces M 11 x 1.5

842-011 x 1,5/10			135141
------------------	--	--	--------

Thread Repair Set M 12

14 pieces:			
10 threaded inserts M 12 x 1.75 x 16.3 mm			
1 piece each: twist drill, tap, installation tool, pin breaking tool			
842-12/14	M 12 x 1,75	16.3	119530

Refill Set 10 pieces M 12 x 1.75

842-012/10			124480
------------	--	--	--------

Thread Repair Set M 12

14 pieces:			
10 threaded inserts M 12 x 1.0 x 17 mm			
1 piece each: twist drill, tap, installation tool, installation tool, pin breaking tool			
842-12 x 1,0/14	M 12 x 1,0	17	135066

Refill Set 10 pieces M 12 x 1.0

842-012 x 1,0/10			135172
------------------	--	--	--------

Thread Repair Set M 12

14 pieces:			
10 threaded inserts M 12 x 1.25 x 16.8 mm			
1 piece each: twist drill, tap, installation tool, pin breaking tool			
842-12 x 1,25/14	M 12 x 1,25	16.8	135059

Refill Set 10 pieces M 12 x 1.25

842-012 x 1,25/10			135158
-------------------	--	--	--------

Thread Repair Set M 12

14 pieces:			
10 threaded inserts M 12 x 1.5 x 16.5 mm			
1 piece each: twist drill, tap, installation tool, pin breaking tool			
842-12 x 1,5/14	M 12 x 1,5	16.5	128648

Refill Set 10 pieces M 12 x 1.5

842-012 x 1,5/10			128785
------------------	--	--	--------

Thread Repair Set for spark plug threads M 14 x 1.25

17 pieces:			
5 threaded inserts M 14 x 1.25 x 16.4 mm			
5 threaded inserts M 14 x 1.25 x 12.4 mm			
5 threaded inserts M 14 x 1.25 x 8.4 mm			
1 piece each: tap, installation tool			
842-14/17	M 14 x 1,25		119547

Refill Set 10 pieces M 14 x 1.25

842-014/10			124497
842-014 A/10			126354
842-014 B/10			126347

Thread Repair Assortment

130 pieces:			
25 threaded inserts M 5 x 0.8 x 6.7 mm			
25 threaded inserts M 6 x 1.0 x 8.0 mm			
25 threaded inserts M 8 x 1.25 x 10.8 mm			
25 threaded inserts M 10 x 1.5 x 13.5 mm			
10 threaded inserts M 12 x 1.75 x 16.3 mm			
5 each twist drills, taps, installation tools, pin breaking tools			
842-512/130	M 5-M 12		119554

Thread Repair Set

Length dimensions l_{mm} of the built-in threaded inserts (E)

HAZET No.	M	l mm	EAN-No. 4000896+
Thread Repair Assortment			
87 pieces:			
25 threaded inserts M 6 x 1.0 x 8.0 mm			
25 threaded inserts M 8 x 1.25 x 10.8 mm			
25 threaded inserts M 10 x 1.5 x 13.5 mm			
3 each twist drills, taps, installation tools, pin breaking tools			
842-610/87	M 6-M 10	-	129669

Thread Repair Assortment

113 pieces:			
25 threaded inserts M 6 x 1.0 x 8.0 mm			
25 threaded inserts M 8 x 1.25 x 10.8 mm			
25 threaded inserts M 10 x 1.5 x 13.5 mm			
10 tap inserts M 12 x 1.75 x 16.3 mm			
10 tap inserts M 14 x 1.25 x 16.4 mm			
4 each twist drills, pin breaking tools, 5 taps, installation tools			
842-614/113	M 6-M 14	-	119561

Universal Thread Repair Tool



For thread diameters 4–13 mm ($\frac{5}{32}$ " – $\frac{1}{2}$ " (N))

- Quick fixation with setting screw
- Automatic adjustment of the blade on each thread pitch
- For plugging taps of right and left threads (Attention to direction of rotation!)
- For all metric and non-metric threads

HAZET No.	M	l mm	EAN-No. 4000896+
842 AG-1	4–13 mm	$\frac{5}{32}$ " – $\frac{1}{2}$ "	140718

Single-Cut Tap / Drill Set



- For cordless screwdrivers / drills and power drills with forward and reverse

- **One working step:** taper tap – plug tap – bottoming tap combined in one tool

- High-quality HSS-G twist drill bits
- Bit holder with clamping spring (non magnetic) allows fast changing of the drill and tapping bits
- Set of 13 pieces in plastic box

Contents:
6 Tapping Bits, form D M 3 4 5 6 8 10
6 Twist Drill Bits, HSS-G 2.5 3.3 4.2 5.0 6.8 8.5 mm
1 Bit Holder with clamping spring
○ D 6.3 = $\frac{1}{4}$ " – ● C 6.3 mm

HAZET No.	d mm	l mm	EAN-No. 4000896+
842 BG/13			125135

Single-Cut Tap Set



- **One working step:** taper tap – plug tap – bottoming tap combined in one tool

- For cordless screwdrivers/drills and power drills with forward and reverse
- High-quality HSS-G tapping bits
- 6 pieces in plastic case

Contents:
6 tapping bits, form D M 3 4 5 6 8 10

HAZET No.	d mm	l mm	EAN-No. 4000896+
842 G/6			125142

Combined Drill / Tapping Bit Set



- **Drilling the hole and tapping without having to change the tool** – 4 tools in one (drill bit, taper tap, plug tap and bottoming tap)

- For tapping through threads with a thread depth of twice the thread diameter. (Ensure the speed (rpm) is adapted to the corresponding working step.)

- For cordless screwdrivers/drills and power drills with forward and reverse

- Universal application on materials of medium hardness

- Set of 7 pieces in plastic box

Contents:
6 Drill/Tapping Bits M 3 4 5 6 8 10
1 Bit Holder with clamping spring
○ D 6.3 = $\frac{1}{4}$ " ● C 6.3 mm

HAZET No.	d mm	l mm	EAN-No. 4000896+
842 B/7			125159

Stud Extractor



- For installing and removing stud bolts and set screws with right-handed or left-handed thread without damage

- □ drive 12.5 = $\frac{1}{2}$ " or \leq 21 mm outside hexagon

- Chrome-Vanadium

- Surface chrome-plated and polished

HAZET No.	d mm	l mm	EAN-No. 4000896+
844- 6	23,6	65	035823
844- 7	23,6	65	035830
844- 8	23,6	65	035847
844-10	27,0	75	035809
844-12	27,0	75	035816

Thread Repair Screwed Connections

Stud Extractor Set

(E) 12⁵/₁₆



187 x 125 x 39 mm



- In plastic case
- With PUR foam insert

HAZET No. EAN-No. 4000896+

4 pieces

Contents:

844-6 8 10 12

844/4 035854

5 pieces

Contents:

844-6 7 8 10 12

844/5 035878

Stud Extractor

(N)



- For turning in and out stud bolts (set screws) with right-handed or left-handed thread
- Special steel
- Surface galvanized

HAZET No. EAN-No. 4000896+

845-1 6-13 141739

845-2 5-19 141661

Hydraulic Nut Splitter

(N)



- For splitting tight nuts of the quality ranges 5, 6, 8 and 10
- Special steel

HAZET No. EAN-No. 4000896+

846-22 A 7-22 140435

846-36 A 22-36 140442

Mechanical Nut Splitter

(E) (N)



- For splitting tight nuts of the quality ranges 5 and 6

HAZET No. EAN-No. 4000896+

847-0410 A 7-16 139903

847-1027 A 13-24 139910

847-1736 A 21-36 139927



Spare Chisel for 847-0410 A and 1027 A

847-10 A 144150

Spare Chisel for 847-1736 A

847-17 A 144167

Flare Nut Insert Tool (12-Point)



- Crowfoot Wrench
- For union nuts and tube connections
- Metric sizes

HAZET No. EAN-No. 4000896+

848 Z-10 6.3 1/4 079049

848 Z-12 6.3 1/4 079056

848 Z-13 6.3 1/4 079063

848 Z-14 6.3 1/4 079070

848 Z-16 10 3/8 079087

848 Z-17 10 3/8 079094

848 Z-18 10 3/8 079100

848 Z-19 10 3/8 079117

848 Z-21 10 3/8 079124

848 Z-22 10 3/8 079131

848 Z-24 10 3/8 079148

848 Z-27 10 3/8 079162

848 Z-30 12.5 1/2 079179

848 Z-32 12.5 1/2 079186

848 Z-36 12.5 1/2 079193

848 Z-41 12.5 1/2 079216

848 Z-46 12.5 1/2 079223

Tap and Die Set

(E)



279 x 121 x 47 mm

- For problem-free **rethreading** even in areas with restricted access
- To be used with reversible ratchet
- Heavy-duty thread cutter made of HSS steel
- In black plastic box
- With PUR foam insert

Contents:

849 IG- M3 M4 M5 M6 M8 M10 M12

849 AG- M3 M4 M5 M6 M8 M10 M12

849 IG-6,3 8 849 AG-6,3 10

2100-025 2250-1 3

HAZET No. EAN-No. 4000896+

849 035984

Spare Parts:

Taps for female threads

849 IG-M 3 036127

849 IG-M 4 036134

849 IG-M 5 036141

849 IG-M 6 036158

849 IG-M 8 036165

849 IG-M 10 036103

849 IG-M 12 036110

Dies for male threads

849 AG-M 3 036035

849 AG-M 4 036042

849 AG-M 5 036059

849 AG-M 6 036066

849 AG-M 8 036073

849 AG-M 10 036011

849 AG-M 12 036028

Chuck

● 6.3 = 1/4", for taps 849 IG-M 3 up to M 6 (in conjunction with Adapter 2250-1)

849 IG-6,3 036080

Chuck

● 8 = 5/16", for taps 849 IG-M 8 up to M 12 (in conjunction with Adapter 2250-3)

849 IG-8 036097

Die Stock

□ drive 6.3 = 1/4", for dies 849 AG-M 3 up to M 6

849 AG-6,3 036004

Die Stock

□ drive 10 = 3/8", for dies 849 AG-M 8 up to M 12

849 AG-10 035991

Adapter

for dies according to DIN EN 22568 in connection with 849 AG-6,3 -10

849 AG-20 061105

849 AG-30 061112

849 AG-38 061129

Hex Head Wrench

2100-025 2,5 58,5 20,5 011285

Adapters for manual operation

With inside square and inside hexagon insert

With clamping ball for bits

Chrome-Vanadium, Surface chrome-plated

2250-1 6,3 = 1/4" 6,3 = 1/4" 23,5 015443

2250-3 8 = 5/16" 10 = 3/8" 31 015474